

CABLELINE ▶ AMBASSADOR

FEATURES

180 x 52mm Profiles

Three Compartments

Three Lids

- Screw-on corner fittings for added security
- Can be sub-divided
- Wood effect options
- DC3 curved profile for larger cabling capacity
- Accommodates 25mm and 35mm deep boxes for a wide range of accessories
- Accepts all leading wiring accessories including Clicline
- Carpet inlay allows for less intrusive installation
- Optional data cable guide enables cable to maintain a minimum bend radii

Standards: BS 4678-Pt4, BS7671 (IEE Regs), BS6701, BSEN 50173, BSEN 50174-2, (CENELEC), ANSI/TIA/EIA 586B, ISO IEC 11801.

Cableline Ambassador - profile DP3 at dado level, DS3 at skirting level. Inset - DS3 with inlaid carpet.

SELECTOR CHART Choose from 3 distinct profiles.

Product	Length	Material	Colours/Finishes Available	Cableline Plus Compatible	Available as PowerTrack See Pages 28-29	Available Prewired See Pages 65-67	Compatible with Clicline Wiring Accessories See Pages 50-55	Accepts Socket Mounting Boxes	
								25mm deep	35mm deep
DP3	3m	uPVC	Standard: Alpine White, Wood Effect: Light Oak, Mid Teak, Mahogany	✓	✓	✓	✓	✓	✓
DS3	3m	uPVC	Standard: Alpine White, Wood Effect - Light Oak Other Colour Options: RAL Colours, Wood Effects	✓	✓	✓	✓	✓	✓
DC3	3m	uPVC	Standard: Alpine White, Wood Effect - Light Oak Other Colour Options: RAL Colours, Wood Effects	✓	✓	✓	✓	✓	✓

- Combinations of wood effect trunking lengths and wood effect/painted fittings.
- Please contact our sales office for minimum quantities, lead times and price information.

▶ TRUNKING ASSEMBLIES AND FITTINGS

▶ Trunking Assemblies

Ref Size Packed
DP3 180 x 52mm 2 x 3m

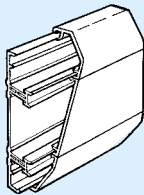

Ref Size Packed
DS3 180 x 52mm 2 x 3m

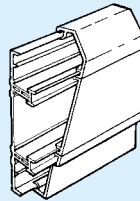

Ref Size Packed
DC3 180 x 52mm 2 x 3m

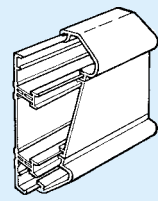

▶ External Angle Inc. continuity piece

Ref To suit Ambassador Profile Packed
DPX 3 DP3 1
DSX 3 DS3 1
DCX 3 DC3 1

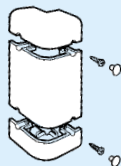

▶ Internal Angle

Ref To suit Ambassador Profile Packed
DPI 3 DP3 1
DSI 3 DS3 1
DCI 3 DC3 1

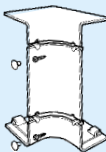

▶ Flat Angle

Ref To suit Ambassador Profile Packed
DPF 3 DP3 1
DSF 3C DS3 1
DSF 3R DS3 1
DCF 3 DC3 1

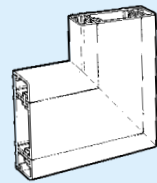

DSF3C has a chamfered inner lid and a skirting base outer lid. DSF3R has a skirting base inner lid and a chamfered outer lid.

▶ Data Cable Guide
DCGA 2

▶ Flat Tee

Ref To suit Ambassador Profile Packed
DPT3 DP3 1
DST3C DS3 1
DCT3 DC3 1

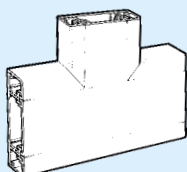

Includes one crossover unit Ref. DLO3

▶ Data Cable Guide
DCGA 2

▶ Joint Cover

Ref To suit Ambassador Profile Packed
DPJ 3 DP3 2
DSJ 3 DS3 2
DCJ 3 DC3 2



▶ End Caps

Ref To suit Ambassador Profile Packed
DPE 3 DP3 2
DSE 3L DS3L.H 2
DSE 3R DS3R.H 2
DCE 3 DC3 2

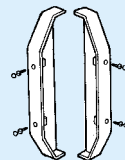

DP3

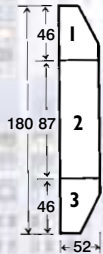

DS3

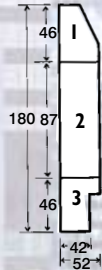

DC3

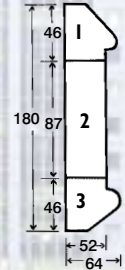

For cable capacity charts please refer to the Technical Section

COMPONENTS (White unless shown otherwise)

BOXES & FRAMES

Socket Mounting Boxes

Size	Ref	Packed
1 gang 25mm deep	CLB 3-1	10
1 gang vertical mounting box 25mm deep	CLB 3-1/4	10
1 gang 35mm deep	CLB 4-1	10
2 gang 25mm deep	CLB 3-2	10
2 gang 35mm deep	CLB 4-2	10

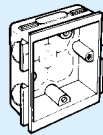

Screened Socket Mounting Boxes

Size	Ref	Packed
1 gang 25mm deep	CLBS 1	10
1 gang vertical mounting box 25mm deep	CLBS 1/4	10
1 gang 35mm deep	CLBS 3	10
2 gang 25mm deep	CLBS 2	10
2 gang 35mm deep	CLBS 4	10



Extension Collars

Size	Ref	Packed
1 gang 10mm deep	CEC 110	10
1 gang 19mm deep	CEC 119	10
2 gang 10mm deep	CEC 210	10
2 gang 19mm deep	CEC 219	10

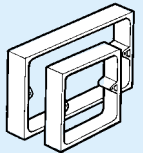

Mounting Frames

for 45 x 45mm Accessories

Type	Ref	Packed
1 gang	ATMF 451	15
2 gang	ATMF 452	10



Socket Mounting Plate

Type	Ref	Packed
1 gang	CTMP 1	15
2 gang	CTMP 2	10

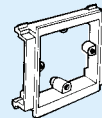

Mounting Frames

for Eurica Accessories

Type	Ref	Packed
1 gang	EAMF 1	15
2 gang	EAMF 2	10
2 x 1 gang	EAMF 3	10



ACCESSORIES

MCB/RCD Housing

Complete with DIN mounting rail and 2 Joint Covers

To suit	Ref	Packed
Profile: DP3, DS3, DC3 Housing Unit only	DCH 3	1
Housing Unit with Cover	DCHC 3	1

See Technical Section for MCB/RCD suitability.

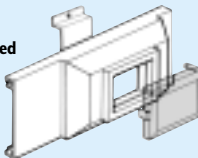

Screening Divider (Illustrated in Grey)

Size	Ref	Packed
34mm x 1mm	SS34	4x1.5m

For further details, please refer to the Technical section. Other options are available. Contact us for further information.

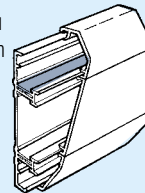

Rear Cable Entry Box

Ref	Packed
CBB3	1

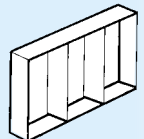

Mini Trunking Adaptors

Self Adhesive

Size	Ref	Packed
16 x 16mm	CLA 3-1	5
25 x 16mm	CLA 3-2	5

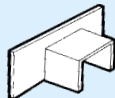

Cross Over Unit (Colour Red)

Size	Ref	Packed
For Ambassador	DLO 3	5



Cable Hanger (Colour Red)

Ref	Packed
CLH 3	10

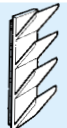

Cable Retainers

Type	Ref	Packed
Chamfered outer	DPC3-T	20
Centre	DLC3-M	10
Skirting Base	DSC3-T	20

